

Romacon Ductile Iron Tapping Saddle (DTS)

ROMACON®

Romacon Ductile Tapping Saddles are used to make permanent (hot) taps on existing or new pipe lines for water and gas pipes

Characteristics of the Romacon DTS Saddle

- Solid, well thought-out construction.
- High quality GGG 50 ductile iron.
- Produced according to DIN 3543, Part 1.
- Saddle is provided with epoxy coating, EWS epoxy according GSK-diridives RAL-G2-662 DVGW-W-270, which prevents rust.
- DVGW (G87 e 087) approved.
- Perfect seal through flat O-ring, which is enclosed in the chamber of the alignment saddle (see drawing). Through a special combination of O-ring and flat ring, a two-fold seal is obtained.
- Ring gasket approved by KTW and DVGW. (G8501 e 608). Standard Rubber is EPDM.
- Applicable for gas (NBR Rubber is available on request) and water pipes.
- Applicable for various types of material, such as asbestos-cement, cast iron and steel.
- Very suitable for pipes covered with polyethylene.
- When the Romacon DTS Saddle is placed, the polyethylene layer does not have to be removed.
- Test report on request.
- Wide, 100% stainless steel lower bracket.
- Lower bracket provided with a special rubber band.
- Stainless steel, electrolytic zinc plated nuts, to prevent fretting.
- One saddle for various diameters, from DN 40 to DN 600. Reduces stock.
- Suitable for alignments under pressure.

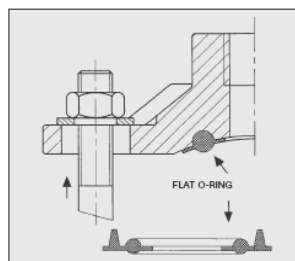
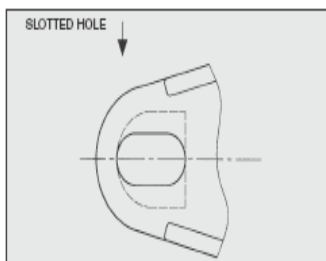

Applications of the Romacon DTS Saddle
The Romacon DTS Saddle can be used to make taps on all pipe types except PE for water and gas applications.

This saddle is ideal for pipes covered with polyethylene, but also fits old pipes perfectly.

Dimensions of the Romacon DTS Saddle

- The Romacon DTS Saddle can be supplied with a tapped service outlet of 1/2" up to including 2".
- Special service outlets are available on request.
- The Romacon DTS Saddle can be supplied from DN 40 up to including DN 600.
- Strap width 60 mm
- Available with branch according to Polva 1 1/2" to 2".

DN in mm	Working Range
50	44-57
50	58-72
60	72-82
80	82-102
80	88-108
100	106-130
125	129-158
150	159-186
175	184-210
200	211-244
225	244-266
250	264-298
300	315-358
325-600	On request



Romacon has been certified to ISO 9001:2008 by Tüv